



**VERDE EN
RESPLANDOR**

ROWHOMES



A manifestation of nature in all her glory and splendour,
With her innumerable personas, shades, and colours,
Melodies, sights, and bouquets of wonder,
A haven for well-being amidst verdure,
This is green in radiance, this is Verde En Resplandor.



Artist's Impression



Exclusive. Luxurious. Serene.
Reconnect with nature.

Contemporary design.

Idyllically located.

Commune with the like-minded;
thought leaders, achievers, the exceptional.

Embrace space.

Live the luxurious villa life.

Find your home at Trifecta Verde En Resplandor.





Rediscover fresh air, and breathe again
Embrace space and stay safe, live a less crowded life
Embrace the integrated lifestyle at Club Verdant

Thrive in The Great Outdoors amidst bountiful and beautiful landscaping
Private garden space, just for you and no one else
Personal space, enjoy being alone in your thoughts

More rooms, more spaces, and multiple floors, great for growing families
Nearly double the undivided share than that of an apartment
10% to 40% premium on rental income over an apartment
Better appreciation and a sound investment

All of the above, for the price of an apartment.

Conveniences



Work

- ° KIADB Aerospace SEZ 6.5 km
- ° KIADB IT Park 6.7 km
- ° Bearys Global Research Triangle 9 km
- ° ITPB 17 km
- ° Manayata Tech Park 20 km



Travel

- ° Whitefield Train Station 15.2 km
- ° Kempegowda International Airport 20 km
- ° KR Puram Station 17.7 km
- ° Proposed Extension of Metro to Airport



Shop & Entertain

- ° Brigade Upton Orion Mall 6.6 km
- ° Forum Shantiniketan Mall 18 km
- ° Phoenix Marketcity 19 km
- ° VR Bengaluru 19 km



Live

- ° East Point Hospital 9.5 km
- ° Ovum Woman & Child Speciality Hospital 10.5 km
- ° MVJ Medical College & Hospital 13.5 km
- ° Sathya Sai Orthopaedic Hospital 13 km
- ° Manipal Hospital 17 km
- ° Cloudnine Hospital 19.3 km
- ° Vydehi Hospital 20 km
- ° Columbia Asia Hospital 20.7 km



Learn

- ° Narayana e-Techno School 4.3 km
- ° New Baldwin International Residential School 5 km
- ° Shri Ram Global School 5.2 km
- ° Sishu Griha 6.5 km
- ° VIBGYOR School 9.6 km
- ° MVJ Medical College & Hospital 13.5 km
- ° Capstone High School 13.3 km
- ° Delhi Public School North 17 km

West Facing Rowhomes



Ground, First & Second Floor Isometric Views

West Facing Rowhomes



Ground Floor Plan

West Facing Rowhomes



First Floor Plan

West Facing Rowhomes



Second Floor Plan

East Facing Rowhomes



Ground Floor Isometric View

East Facing Rowhomes



Ground Floor Plan

East Facing Rowhomes



First Floor Plan

East Facing Rowhomes

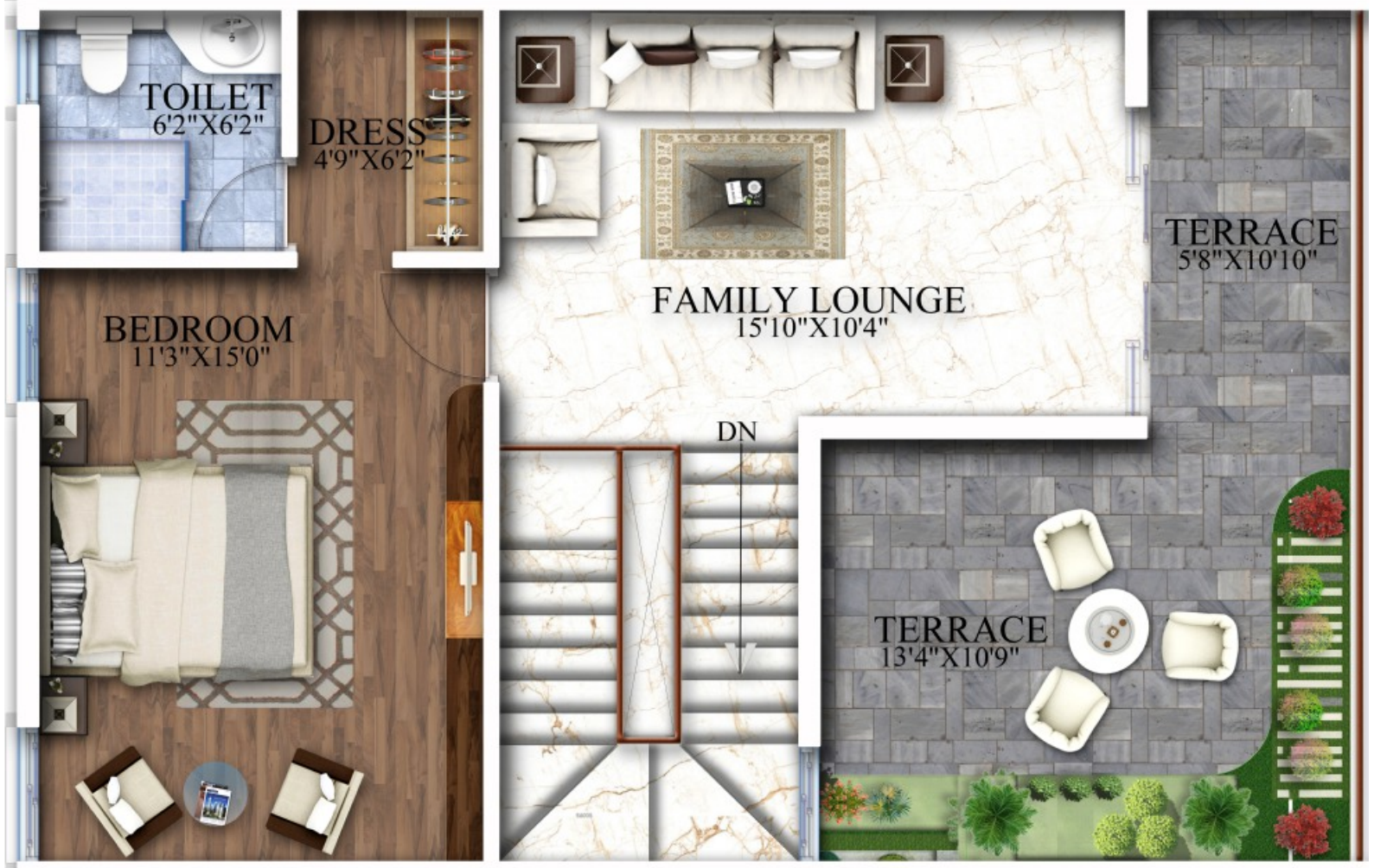

Second Floor Plan

Construction Specifications

Blocks

Wienerberger / equivalent

Electrical wires

KEI / equivalent

Electrical switches

Honeywell / equivalent

Windows

UPVC / Fenesta windows

Doors

Main Door: Teak wood frame and moulded skin shutter

Bedroom: Sal wood frame with moulded skin shutter

Toilet: Sal wood frame with water proof moulded skin shutter

Locks & hardware

Yale / equivalent

Staircase railing

SS Glass railing

Sink

Franke / equivalent

Plumbing pipes

Astral / equivalent

Sanitary

VitrA / equivalent

CP fittings

VitrA / equivalent

Flooring

Diana Italian Marble / equivalent

Imported Laminated Wooden Flooring
for all Bedrooms

Granite flooring:
Staircase

Anti-skid tiles:
Terrace
Toilet
Utility

Paint

Asian Paints / equivalent



Backed by over two decades of experience in the construction sector,
Trifecta Projects is a leading real-estate developer in Bengaluru.

We have consistently delivered over 40% average asset appreciation to our customers,
ensured on-time delivery, provided industry-leading value, maintained transparency,
as well as continuous customer support.

Our values and beliefs have held us in good stead through our journey thus far.
We are principled in our decisions and courageous to keep them.
We are generous and empathetic and remain steadfast in our path.

Rera: PRM/KA/RERA/1250/304/PR/200323/003374

Ecstasy Projects Pvt. Ltd. Trifecta Adatto, 13th Floor, Site No. 66/2, 67/1, Whitefield Main Road,
Garudacharpalya, Mahadevpura Post, Bangalore - 560048

Reach out at: **+91 808 800 4411** | www.trifectaprojects.com | info@trifectaprojects.com